

**YUTZY**  
MADE IN USA

# Home Collection

Solid Wood Office, Occasional & Entertainment Furniture



06  
25

[UrbanCollectionsOhioUSA.com](http://UrbanCollectionsOhioUSA.com)



# Contents

## The Yutzy Difference

■ Home Furniture at a Glance	4
■ What Sets Us Apart	5
■ Why Choose Yutzy?	5
■ Our Story	6
■ Guiding Principals	6
■ Customer Service	6
■ Structure	7
■ Finishes	8
■ Quality Assurance	9
■ Packaging/Delivery	10
■ Warranty	11
■ PRIME Program	12
■ Care	13

## Bordeaux Collection

■ Office Furniture	16-20
■ Occasional Furniture	21

## Cortland Collection

■ Office Furniture	22-26
■ Occasional Furniture	27

## Glacier Collection

■ Office Furniture	28-29
■ Occasional Furniture	30-31

## Harper Collection

■ Office Furniture	32-33
■ Occasional Furniture	34-35

## Jackson Collection

■ Occasional Furniture	36-37
------------------------	-------

## Jamestown Square Collection

■ Occasional Furniture	38-39
------------------------	-------

## Liberty Collection

■ Office Furniture	40-41
■ Occasional Furniture	42-43

## Naples Collection

■ Occasional Furniture	44-45
------------------------	-------

## Reminisc Collection

■ Office Furniture	46-51
--------------------	-------

## Rialto Collection

■ Office Furniture	52-55
■ Occasional Furniture	56-59

## Trieste Collection

■ Office Furniture	60-64
■ Occasional Furniture	65-69

## Chairs

70-77

## Chair Options

78

## Stools

79

## Stains

80-87



Thoughtful Design.  
 Premium Materials.  
 Meticulous Craftsmanship.  
 Beautiful Finishes.  
 Customer Satisfaction.



At Yutzy we design and build furniture that is functional, beautiful and desirable. Furniture that is built to be cherished for generations.

# Home Furniture

## Customer Orientation

**Subject:** Construction details of our heirloom quality home furniture

In our Ohio Shop Yutzy craftsman build our furniture with precision and focused attention to detail using traditional time-honored techniques that are the hallmarks of quality furniture.

## Details that set our home furniture apart.

### Solid Wood Construction

We use only the finest hardwoods, ensuring durability and timeless beauty in every piece.

### Dovetail Drawer Joints

(A) A feature of fine woodworking. This method of joinery offers superior strength and longevity.

### Mortise and Tenon Joints

(B) For superior strength and stability, our tables and chairs are built with mortise and tenon joints.

### (C) The Right Fastening Method

Using the right fasteners is crucial to the dimensional accuracy and longevity of the piece. We use stainless steel screws and glue in the construction of our furniture. Never staples or camlocks.

### Hand-Applied Finishes

Our one of a kind, eco-friendly, finishes are applied by hand to every piece. This approach illustrates our dedication to creating a beautiful, durable finish.

### Customization Options

From wood types to finishes to hardware, we offer a diverse range of customization options to suit any style.

### Sustainability

A commitment to responsible sourcing of wood from sustainable forests.

With this knowledge, you'll be able to confidently showcase the unique value of Yutzy to every customer.

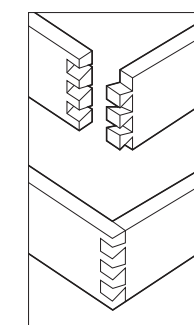
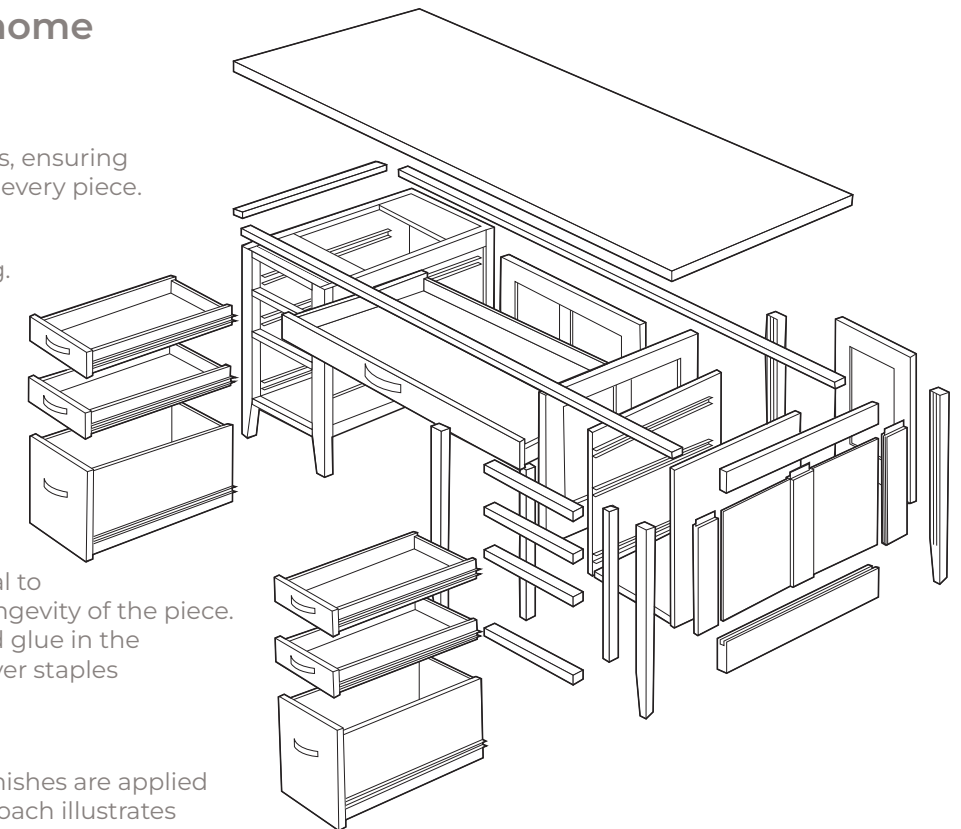

(A)

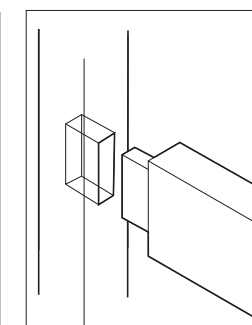

(B)

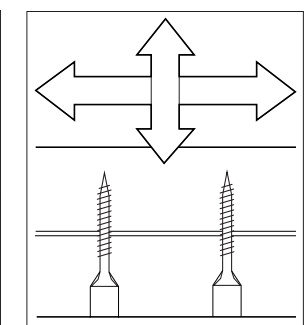

(C)

## Why Choose Yutzy Home Furniture?

Unwavering dedication to design, craftsmanship and exceptional quality. Every piece is designed and built to be both functional, beautiful *and* desirable.

When you sell Yutzy furniture, you're offering your customers more than just a product – you're guiding them to heirloom-quality furniture that will be cherished for generations.



# The Yutzy Difference



## OUR GUIDING PRINCIPALS

### CORE VALUES

- Integrity
- Dependability
- Quality
- Unity
- Innovative

### VISION

To lead American furniture manufacturing with superior design, premium materials, unmatched craftsmanship and outstanding customer service. And to serve those around us for a better future

### MISSION

To design and build solid wood furniture that will be cherished for generations.

Yutzy started with the dream of building solid wood, heirloom quality furniture in America solidly rooted in Amish principles— humility, family and community.

Closely adhering to those principles the second generation is now guiding the company alongside the first, anticipating future trends and thoughtfully broadening our product offerings. Second generation ambition combined with traditional Amish principals continues the culture of building furniture that will be cherished for generations.

### Serving the Customer

Through our accomplished sales and customer service teams, Yutzy is committed to customer satisfaction. We cater to the needs of our customers the traditional way; personal interaction. Call and you'll get an authentic, empathetic person who is ready to serve you instead of the now common, and frustrating, automated customer support phone tree or chatbot.

# Structure



We build every piece with an unwavering commitment to quality and the preservation of time-honored traditions. Meticulous craftsmanship, high-quality materials, and time-honored woodworking techniques create family heirlooms that withstand the test of time.



### Drawers



### Strength, aesthetics & longevity.

All drawers (A) are solid wood with dovetail construction and are a standard of fine furniture craftsmanship.

All drawers (B) are full extension soft close with side mount drawer slides.

### Tops & Sides



Solid wood tops & side panels.

### Back Panel



Framed fitted back panels.

### Stability

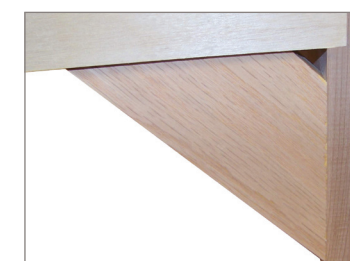

Built-in corner stability.

### Spacer Balls

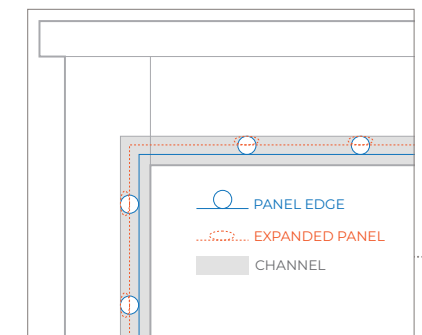

Side panel detail not to scale

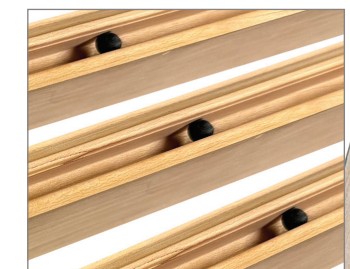

Floating spacer balls keep panels centered and rattle free. Absorbs panel expansion and eliminates panel cracking and damage.

*All*  
SOLID WOOD  
CONSTRUCTION



# Incomparable Finishes

We take pride in our high-quality finishes that balance beauty and durability and is the final step in the crafting of our fine solid wood furniture.

## The Perfect Finish is Comprised of 4 Elements.

- 1
- Dust Control
- 2
- Sanding
- 3
- Staining
- 4
- Curing



### Whole shop dust control

A fine finish starts with controlling impurities in the air. We don't just control dust at the sanding stations, we clean the air of the entire shop - from the mill to final inspection. We do this to ensure a flawless, durable finish.



### Sanding

This seemingly simple process is, in fact, a skill demanding patience, precision, and an understanding of the material at hand. The goal is always a smooth surface, devoid of imperfections that still leaves the grain open to accept stain. It also has to be consistent across the whole piece to ensure that the stain penetrates evenly.



### Applying stain

Applying the stain evenly is very important in creating a fine finish. Even stain application paired with skillful sanding ensures consistent color over the whole piece and/or suite of furniture.



### Curing

The final step is applying the oven-cured catalyst that not only resists moisture and chemicals but also keeps them on the surface so they can be wiped up and cleaned thoroughly.

# Quality Assurance



Yutzy consistently delivers industry-leading quality by adhering to a strict quality control process.

Before the finished pieces are packaged for shipping we conduct:

**Visual Inspection:** Visual inspection is the first step in inspecting our finished pieces. This involves closely checking the final product for defects or issues that may affect its quality, such as scratches, dents, or color inconsistencies.

**Dimensional Inspection:** Dimensional inspection involves checking the dimensions of the finished product to ensure that it meets the required specifications.

**Functionality Testing:** Functionality testing involves checking the finished product to ensure that it functions as intended. This includes testing drawers, hinges, locks, and other components to be certain that they work correctly.

Only when our quality control specialist is satisfied that the piece meets our high standards will it be released to our shipping department and carefully packaged to arrive at your store in a condition that will delight you and your customers.



# Packaging and Delivery



## Protecting your furniture during delivery is essential.

We take the same pride in packaging your furniture as we do building it. We use multiple protective materials to ensure that it arrives to you in the condition that it left our shop.

**Closed cell foam:** Used for product and impact protection.

**Corrugated:** The most common protective packaging material. Used for load compression protection, internal blocking and impact protection.

**Plastic wrap:** Clings to the furniture and itself to protect your investment. Secures doors, drawers and panels along with protecting fabric pieces from tears and scratches. Also used to bundle smaller pieces together.

We use these materials individually and in combination to best protect the item to be shipped.

**We also honor special packaging requests such as shipping pieces fully enclosed in corrugated boxes for a nominal up charge.**

Our attention to protecting your order doesn't stop when we're done packaging it. We then carefully load all of our trucks taking the same care we applied to packaging; padded moving blankets, furniture pads, corrugated cardboard sheets, and tie down straps ensure safe delivery.

## PROTECTING YOUR INVESTMENT



Dressers & Chests



Headboard & Side Rails



Table Tops



Mirrors

Table Bases

# Warranty



## Yutzy Woodworking Ltd. Manufacturer's 5 year Limited Warranty

Yutzy Woodworking LTD warrants to the original purchaser, under normal household use and service, all of its furniture products to be free from defects in material and workmanship for a period of five years, following the date of purchase and delivery to the purchaser.

- This warranty does not cover upholstery (fabrics and/or leathers) or damages which result from neglect, accident, or intentional misuse of any nature.
- This warranty does not include institutional use, normal wear and tear, and exposures to extremes in temperature or humidity, immersion in water, fading or variations in color or finish over time, scratches, blemishes or slight color variations in wood grain, unauthorized repair or alteration of the product.
- Because of the characteristics of solid wood, (a natural material) minor variations in color, wood grain, or construction can occur from piece to piece. Therefore, this warranty does not cover such minor differences, or differences between floor samples or printed illustrations and your furniture.
- Seasonal wood movements on solid wood products are normal and are not considered warranty issues.
- Damage occurring during the delivery or set up of your furniture in your home *is not* covered by this warranty and should be addressed with the company making the delivery.
- Always clean and polish furniture with silicon-free and ammonia-free cleaners. Any mild, common dishwashing liquid works as well. Avoid using any solution that contains bleach or abrasives. The retailer that sells Yutzy Woodworking furniture may have a comparable product they may recommend that does not contain ingredients harmful to this superior catalyzed finish.
- This warranty is null and void if a silicone based cleaner or polish is used and damages the finish surface. It is also best to use products free of wax to avoid a wax build up that can not be removed.
- Dressers, Nightstands, Armoires and Chests of any kind, are intended solely for storage. Headboards and footboards are intended solely for the support of mattresses. Occasional tables and media centers are made for storage and surface function as a table for cocktails, as storage for nightstands, and to support media for media centers. Any other use of these products may create a hazard and void this warranty.

The obligation of Yutzy under this warranty is limited, at the option of the manufacturer, to repair or replace the product with a product of equal quality if the original product under warranty is no longer available, within 90 days from the receipt by Yutzy Woodworking of a written recommendation from the dealer. The warranty is good as long as the manufacturer is satisfied the product proves defective under normal household use and with the correct products used for the maintenance of their furniture. Repairs or replacements under this warranty will be made only by Yutzy Woodworking. If the dealer finds return to the factory necessary, packing and shipping cost will be charged to the purchaser. Return Shipping shall be prepaid to the dealer making the recommendation. All cost for delivery from the purchaser to the dealer and any delivery to the purchaser from the dealer shall be paid by the purchaser.



We Live in an On-Demand World.

Streaming movies and music. Drive thru everything.

**Choice. Fast delivery.**

Yutzy has created a program that caters to those buyers who sell high-quality furniture and promise fast delivery.



**INTRODUCING**



*Simple. Fast. Satisfying.*

Our most popular sets and pieces in popular woods and finishes. Handcrafted and ready to leave our shop within 5 business days.

That's our pledge to you.

**How it Works**

- 1 **Select** your piece and finish.
- 2 **Place order**
- 3 **Ready to ship** within 5 business days.

**Look for the the PRIME logo to take advantage of what this collection has to offer.**

Reminisce, Trieste and Champagne Bedrooms. Premium, Single Pedestal and Leg Tables.

**Furniture Care**

**Always**

**Clean Regularly**

Make cleaning and polishing your furniture part of your regular cleaning routine. Doing this lessens the risk of contaminants building up on the surface which could damage the finish and also make them harder to remove.

**Always clean and polish furniture with silicon-free and ammonia-free cleaners.**

**General Cleaning**

- Always use a silicone free or an ammonia free cleaner. A mild dishwashing soap works well too.
- Use a soft cloth to avoid scratches.
- Dry with a soft cotton cloth.

**Polishing**

- Always use silicone-free polish.
- Apply using a soft cloth in the direction of the grain.
- Buff to your desired finish using another soft cloth.

**Protect Surfaces**

Liquid damage occurs quickly; protecting your investment with placemats, tablecloths and coasters will keep contaminants from damaging the fine finish of your furniture.

**Dealing with Spills**

- Act quickly
- Blot, don't rub.
- Use a specialized cleaner if possible.

Regular dusting, wiping, polishing and carefully placing objects like lamps and vases can prolong the life of your furniture.

**Avoid**

**Chemicals**

Keep solvents away from your furniture — they can strip the finish. Some cleaners contain bleach, alcohol or other products that can stain or strip wood. Always keep away from those ingredients and find natural alternatives. If you're not sure what to use, ask your dealer.

**Plastics**

Color from plastics can leach into wood furniture and the heat and humidity they absorb can also damage your furniture. Keep plastic items off your furniture and replace them with cloth alternatives.

**Sunlight**

If possible, keep furniture out of direct sunlight. Sunlight bleaches wood and degrades furniture finishes.

**Heat & Humidity**

Fireplaces, radiators and forced-air furnaces keep a room warm but take a toll on wood furniture. Place furniture as far as possible away from heat sources. Humidity levels expand and contract the wood used to build your furniture and over time this movement can stress the furniture and

**Avoid using any solution that contains bleach, abrasives, silicone or ammonia.**

make it prone to possible damage. Try to keep the humidity level in your home stable especially if you live in an area that experiences a wide range of temperatures and humidity levels.





# At Home



- A. #88005 Double Pedestal Credenza
- B. #88016 Double Pedestal Jr Executive Desk
- C. #88023 Two Drawer Lateral File Cabinet
- D. #88024 Bookcase for Top of Lateral File
- E. #88052 Hutch Top for 60" Credenza

Shown in Maple with 107 Dark Washington stain.  
Hardware: K6060-DBN



**Pop-up Power Outlet** with two electrical and 2 USB ports is Standard in all Executive Desks.

\*Located center of desk



**Grommet is Standard** in all Jr. Executive Desks and Returns.

\*Located right side of knee hole



A. #88021 3 Drawer Cabinet,  
B. #88060 Single Pedestal Executive Desk with Right Side L-Return  
C. #88054 Hutch Top

Shown in Maple with 107 Dark Washington stain.  
Hardware: K6060-DBN



Hutch Top  
#88052 For 60" Credenza/Desk  
16"D x 60"W x 48"H  
#88053 For 66" Credenza/Desk  
16"D x 66"W x 48"H  
#88054 For 72" Credenza/Desk  
16"D x 72"W x 48"H



2 Drawer File Cabinet  
#88022 23"D x 22"W x 35"H



3 Drawer File Cabinet  
#88021 23"D x 22"W x 48"H



4 Drawer File Cabinet  
#88020 23"D x 22"W x 61"H



Bookcase  
#88030 15"D x 24"W x 72"H  
#88034 15"D x 36"W x 72"H  
#88038 15"D x 36"W x 48"H



Executive Bookcase  
with 2 File Drawers  
#88046 20"D x 48"W x 78"H



Executive Bookcase  
with 2 File Drawers and  
Sliding Doors  
#88047 20"D x 48"W x 78"H



Bookcase with Panel Doors  
#88035 15"D x 36"W x 72"H



Bookcase Top for  
Lateral File Cabinet  
#88024 18"D x 37"W x 42"H



2 Drawer Lateral File Cabinet  
#88023 21"D x 36"W x 35"H

# Bordeaux

OFFICE



## ENTERTAINMENT



**Single Pedestal Desk**  
#88001 24"D x 54"W x 30"H / Knee-hole 31"W x 25"H



**Double Pedestal Credenza**  
#88005 24"D x 60"W x 30"H / Knee-hole 26"W x 25"H  
#88017 24"D x 72"W x 30"H / Knee-hole 30"W x 25"H  
#88003 24"D x 66"W x 30"H / Knee-hole 24"W x 25"H



**Double Pedestal Jr. Executive Desk**  
#88014 30"D x 60"W x 30"H / Knee-hole 26"W x 25"H  
#88015 30"D x 66"W x 30"H / Knee-hole 25"W x 25"H  
#88016 30"D x 72"W x 30"H / Knee-hole 30"W x 25"H



**Double Pedestal Executive Desk**  
#88004 36"D x 66"W x 30"H / Knee-hole 26"W x 25"H  
#88006 36"D x 60"W x 30"H / Knee-hole 24"W x 25"H  
#88007 36"D x 72"W x 30"H // Knee-hole 30"W x 25"H

**Single Pedestal Executive Desk**  
30"D x 72"W x 30"H  
#88060 with Right Side L-Return  
25"D x 52"W x 30"H  
#88061 with Left Side L-Return  
25"D x 52"W x 30"H



#3002 19"D x 70"W x 36"H  
Room Server (optional wood doors)

Shown in Maple with 226 Coffee stain.  
Hardware: BP29349-AS

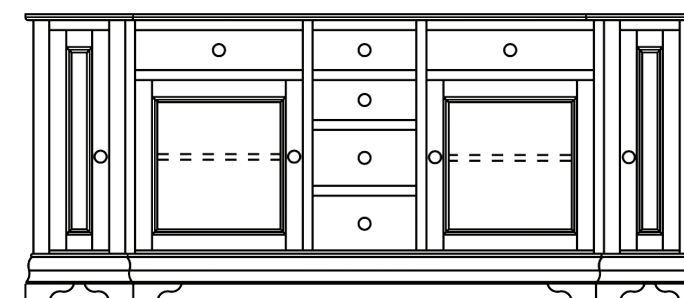

Console #3003 19"D x 85"W x 36"H

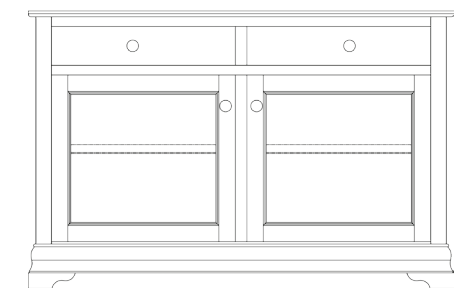

Console #3001 19"D x 55"W x 36"H



**A. #88160** Single Pedestal Executive Desk with right side return

**B. #88147** Executive Bookcase with Sliding Doors and Two Drawers

**C. #88134** Bookcase

**D. #88120** 4-Drawer File Cabinet

Shown in Retreat Cherry with 228 Rich Tobacco stain.  
Hardware: K558-BL & K58-BL



Pop-up Power Outlet with two electrical and 2 USB ports is Standard in all Executive Desks.

\*Located center of desk



Grommet is Standard in all Jr. Executive Desks and Returns.

\*Located right side of knee hole





- A. #88103 Double Pedestal Credenza
- B. #88123 2-Drawer Lateral File Cabinet
- C. #88153 Hutch Top
- D. #620A Callahan Side Chair with Desk Base

Shown in Retreat Cherry with 228 Rich Tobacco stain.  
Hardware: K558-BL & K58-BL

- Hutch Top**
- #88152 For 60" Credenza/Desk  
16"D x 60"W x 48"H
  - #88153 For 66" Credenza/Desk  
16"D x 66"W x 48"H
  - #88154 For 72" Credenza/Desk  
16"D x 72"W x 48"H



- Single Pedestal Executive Desk**  
30"D x 72"W x 30"H
- #88160 with Right Side L-Return 25"D x 52"W x 30"H
  - #88161 with Left Side L-Return 25"D x 52"W x 30"H



**Drawing Desk**  
#88100 24"D x 50"W x 30"H



**Single Pedestal Credenza**  
#88101 24"D x 54"W x 30"H  
Knee-hole 30"W x 25"H



**Sawhorse Desk**

- #88111 30"D x 60"W x 30"H
- #88112 30"D x 66"W x 30"H
- #88113 30"D x 72"W x 30"H

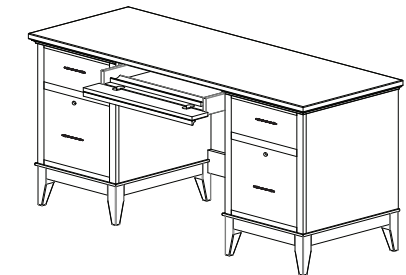

**Double Pedestal Credenza**

- #88103 24"D x 66"W x 30"H / Knee-hole 26"W x 25"H
- #88105 24"D x 60"W x 30"H / Knee-hole 28"W x 25"H
- #88117 24"D x 72"W x 30"H / Knee-hole 32"W x 25"H



**Double Pedestal Jr. Executive Desk**

- #88114 30"D x 60"W x 30"H / Knee-hole 28"W x 25"H
- #88115 30"D x 66"W x 30"H / Knee-hole 26"W x 25"H
- #88116 30"D x 72"W x 30"H / Knee-hole 32"W x 25"H



**Double Pedestal Executive Desk**

- #88104 36"D x 66"W x 30"H / Knee-hole 26"W x 25"H
- #88106 36"D x 60"W x 30"H / Knee-hole 28"W x 25"H
- #88107 36"D x 72"W x 30"H / Knee-hole 32"W x 25"H

OCCASIONAL



2 Drawer File Cabinet  
#88122 23"D x 22"W x 35"H



3 Drawer File Cabinet  
#88121 23"D x 22"W x 48"H



4 Drawer File Cabinet  
#88120 23"D x 22"W x 61"H



2 Drawer Lateral File Cabinet  
#88123 21"D x 36"W x 35"H



Bookcase for Top of Lateral  
File Cabinet  
#88124 18"D x 36"W x 42"H



Bookcase  
#88130 15"D x 24"W x 72"H  
#88134 15"D x 36"W x 72"H  
#88138 15"D x 36"W x 48"H



Bookcase with Panel Doors  
#88135 15"D x 36"W x 72"H

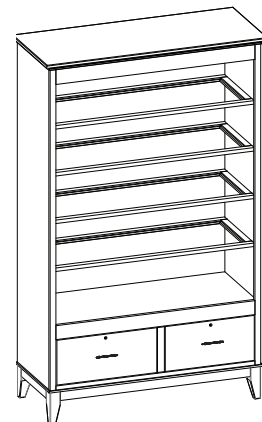

Executive Bookcase with  
2 File Drawers  
#88146 20"D x 48"W x 78"H

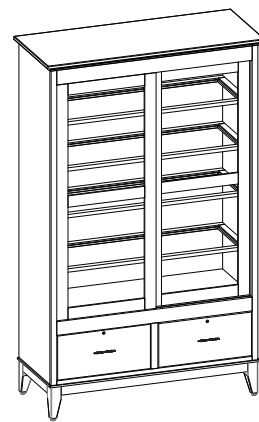

Executive Bookcase with  
2 File Drawers & Sliding Doors  
#88147 20"D x 48"W x 78"H



- A. Cocktail Table with 2 Drawers  
#6102 27"D x 48"W x 19"H
- B. Sofa Table with 2 Drawers  
#6111 18"D x 48"W x 30"H
- C. End Table with Drawer  
#6106 26"D x 23"W x 24"H
- D. Chairside Table with Drawer  
#6108 26"D x 16"W x 24"H

Shown in Retreat Cherry with 228 Rich Tobacco stain.  
Hardware: K558-SI



A. #88471 Writing Desk  
B. #680S Ava Side Chair

Shown in Retreat Cherry with 140 Cappuccino stain.  
Chairs only available in Maple.  
Hardware: Short Pull: BP7345128-CHBRZ  
Knob: BP84150-CHBRZ



#88475 Bookshelf with  
2 drawers and glass doors  
18"D x 22"W x 62"H



#88476 2 Drawer File Cabinet  
18"D x 22"W x 31"H



#88471 Writing Desk  
24"D x 65.5"W x 31.5"H

Hardware Finish Options



**Brushed Nickel**  
Long Pull: BP7345192-195  
Short Pull: BP7345128-195  
Knob: BP84150-195



**Black**  
Long Pull: BP7345192-900  
Short Pull: BP7345128-900  
Knob: BP84150-900



- A. #4701 End Table  
12" Round x 19"H
- B. #4710 Coffee Table  
with glass top  
40" RND x 17.5"H
- #4711 Coffee Table  
(Not shown)  
24" RND x 17.5"H

Shown in Retreat White Oak with YWF 4418 stain.



- #47200 Server  
20"D x 70"W x 40"H

Shown in Retreat Cherry with 140 Cappuccino stain.  
Hardware: Long Pull: BP7345192-CHBRZ



#88601 Harper Desk with Adjustable Standing Lift  
Shown in Wormy Maple with Snow White stain.  
Hardware: 53005-FB



Harper Desk  
#88600 with Solid Top  
30"D x 60"W x 30"H



Harper Desk with lift  
#88601 with Adjustable  
Standing Lift  
30"D x 60"W x 30"H





- A. #2302- Square Cocktail Table
- B. #2301- Round Cocktail Table
- C. #2312- Square End Table
- D. #2311- Round End Table
- E. #2321- Hall Console

**Tables**  
Shown in Retreat White Oak  
with Sea White stain.

**Console**  
Shown in Maple with Saddle stain.



**Round Cocktail Table**  
#2301 36"RND x 19"H



**Round End Table**  
#2311 25"RND x 24"H



**Square Cocktail Table**  
#2302 42"D x 42"W x 19"H  
**Rectangle Cocktail Table**  
#2303 28"D x 48"W x 19"H



**Square End Table**  
#2312 25"D x 25"W x 24"H



**Hall Console**  
#2321 18"D x 70"W x 30"H  
#2322 18"D x 82"W x 30"H  
Shown in Maple with Saddle stain.



Cocktail Table  
#2201 33"D x 50"W x 18"H  
#2202 22"D x 45"W x 18"H

Shown in Wormy Maple with 140 Cappuccino stain, Black glazing and Keepsake finish.



Sofa Table  
#2211 17"D x 60"W x 30"H



End Table  
#2205 20"D x 18"W x 20"H  
#2206 26"D x 22"W x 24"H

# Jamestown Square

OCCASIONAL



**A. Cocktail Table with 2 Drawers**  
#1770 27"D x 48"W x 19"H

**Cocktail Table with 4 Drawers**  
(not shown)  
#1772 42"D x 42"W x 19"H

**End Table with Shelf**  
(not shown)  
#1773 26"D x 23"W x 24"H

**B. End Table with Drawer**  
#1774 26"D x 23"W x 24"H

**C. Chairside Table with Shelf**  
#1776 26"D x 16"W x 24"H

**D. Sofa Table with 2 Drawers & Shelf**  
#1779 18"D x 48"W x 30"H

Shown in Retreat White Oak with 140 Cappuccino stain and Keepsake finish.

Hardware: YWH4518-SAB



A. Library Desk with #12 Leg Option

B. #999S Parsons Side Chair with Desk Chair Base

Shown in Maple with 126 Antique Slate stain with Keepsake finish.

Hardware: YWH1018-OB  
Upholstery: Yukon Graphite  
Nails: Old Brass

**Library Desk**

- #88900 18"D x 36"W x 30"H
- #88901 18"D x 48"W x 30"H
- #88902 18"D x 54"W x 30"H
- #88903 18"D x 60"W x 30"H
- #88904 18"D x 66"W x 30"H
- #88905 18"D x 72"W x 30"H
- #88906 24"D x 36"W x 30"H
- #88907 24"D x 48"W x 30"H
- #88908 24"D x 54"W x 30"H

- #88909 24"D x 60"W x 30"H
- #88910 24"D x 66"W x 30"H
- #88911 24"D x 72"W x 30"H
- #88912 30"D x 36"W x 30"H
- #88913 30"D x 48"W x 30"H
- #88914 30"D x 54"W x 30"H
- #88915 30"D x 60"W x 30"H
- #88916 30"D x 66"W x 30"H
- #88917 30"D x 72"W x 30"H

**LEG OPTIONS**

Also available in Counter Height 36" or Bar Height 42"



**Printer Stand (not shown)**

- #88940 18"D x 22"W x 26"H
- #88941 18"D x 24"W x 30"H
- #88942 18"D x 30"W x 30"H



**Library Desk with Hutch Top**  
(desk shown with #14 Leg Option)

- #88950 Hutch Top  
13"D x 48"W x 21"H
- #88951 Hutch Top  
13"D x 54"W x 21"H
- #88952 Hutch Top  
13"D x 60"W x 21"H

- #88953 Hutch Top  
13"D x 66"W x 21"H
- #88954 Hutch Top  
13"D x 72"W x 21"H



**L Shaped Left Writing Desk**  
(desk shown with Right Return and #15 Leg Option)

- #88920 24"D x 60"W x 30"H
- #88921 24"D x 66"W x 30"H
- #88922 24"D x 72"W x 30"H

**L Shaped Right Writing Desk**

- #88926 24"D x 60"W x 30"H
- #88927 24"D x 66"W x 30"H
- #88928 24"D x 72"W x 30"H

**Right Return Writing Desk**

- #88923 18"D x 36"W x 30"H
- #88924 18"D x 42"W x 30"H
- #88925 18"D x 48"W x 30"H

**Left Return Writing Desk**

- #88929 18"D x 36"W x 30"H
- #88930 18"D x 42"W x 30"H
- #88931 18"D x 48"W x 30"H



A. #88904 Liberty Library Desk  
with Counter Height Legs

B. #503 24" Saddle Stool

Shown in Retreat White Oak  
and YWF 4218 stain.

Upholstered with Desantis  
Mink faux leather and Pewter  
nail heads.



**A. Cocktail Table with Shelf**

#2001 24"D x 48"W x 19"H

#2015 42"D x 42"W x 19"H

#2016 42"D x 60"W x 19"H

**B. End Table**

#2005 24"D x 24"W x 24"H

**C. Console Table**

#2017 18"D x 70"W x 30"H

Shown in Retreat White Oak  
with YWF 4119 Memphis stain/  
shorn edges.

# Reminisce

OFFICE



- A. #88404 Double Pedestal Executive Desk
- B. #88447 Executive Bookcase with 2 File Drawers & Sliding Doors
- C. #88422 2 Drawer File Cabinet
- D. #229A Marquette Arm Chair with 5 star desk base with 5-star gas lift

All pieces shown in Retreat White Oak with 140 Cappuccino stain.

Hardware: 3217-RBZ & 3031-RBZ

Chair upholstered in Broadway Silver faux leather with Old Brass nails.



Pop-up Power Outlet with two electrical and 2 USB ports is Standard in all Executive Desks.

\*Located center of desk



Grommet is Standard in all Jr. Executive Desks and Returns.

\*Located right side of knee hole





**#88415** Double Pedestal Jr. Executive Desk

Shown in Red Oak with 139 Chimney Smoke stain.

Hardware: 3217-RBZ & 3031-RBZ

Writing tray not available on Jr. Executive desks.

**Double Pedestal Jr. Executive Desk**

**#88414** 30"D x 60"W x 30"H  
Knee-hole 26"W x 25"H

**#88415** 30"D x 66"W x 30"H  
Knee-hole 24"W x 25"H

**#88416** 30"D x 72"W x 30"H  
Knee-hole 30"W x 25"H

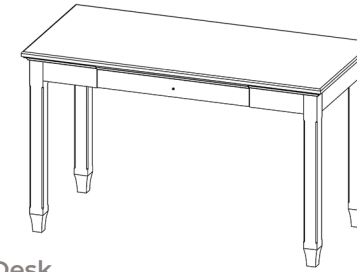

**Drawing Desk**

**#88400** 24"D x 50"W x 30"H



**Single Pedestal Credenza**

**#88401** 24"D x 54"W x 30"H / Knee-hole 30"W x 25"H



**Double Pedestal Credenza**

**#88403** 24"D x 66"W x 30"H / Knee-hole 24"W x 25"H

**#88405** 24"D x 60"W x 30"H / Knee-hole 26"W x 25"H

**#88417** 24"D x 72"W x 30"H / Knee-hole 30"W x 25"H

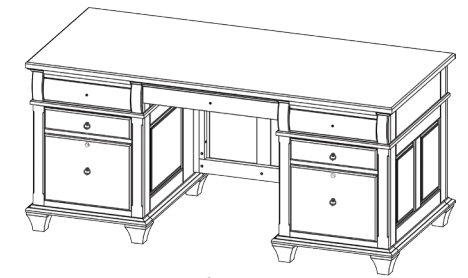

**Double Pedestal Executive Desk**

**#88404** 36"D x 66"W x 30"H / Knee-hole 24"W x 25"H

**#88406** 36"D x 60"W x 30"H / Knee-hole 26"W x 25"H

**#88407** 36"D x 72"W x 30"H / Knee-hole 30"W x 25"H



**Single Pedestal Executive Desk**

30"D x 72"W x 30"H

**#88460** with Right Side L-Return 25"D x 52"W x 30"H

**#88461** with Left Side L-Return 25"D x 52"W x 30"H

Shown in Wormy Maple with 136 Rustic Gray stain.  
Hardware: 3217-RBZ



# Reminisce

OFFICE

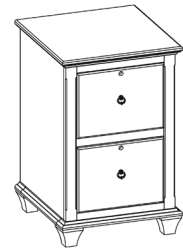

**2 Drawer File Cabinet**  
#88422 23"D x 22"W x 35"H

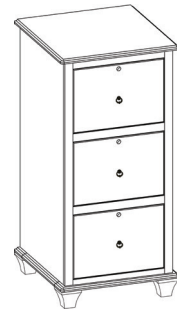

**3 Drawer File Cabinet**  
#88421 23"D x 22"W x 48"H

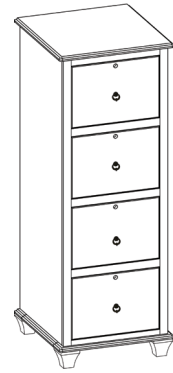

**4 Drawer File Cabinet**  
#88420 23"D x 22"W x 61"H

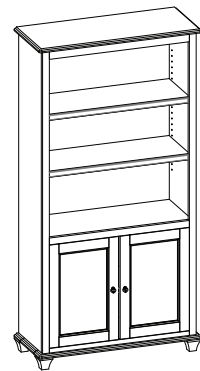

**Bookcase with Panel Doors**  
#88435 15"D x 36"W x 72"H

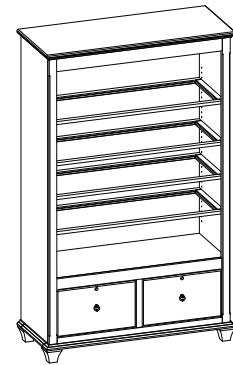

**Executive Bookcase with 2 File Drawers**  
#88446 20"D x 48"W x 78"H

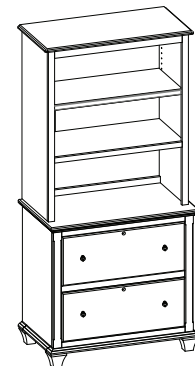

**Bookcase for Top of Lateral File Cabinet**  
#88424 18"D x 36"W x 42"H  
**2 Drawer Lateral File Cabinet**  
#88423 21"D x 36"W x 35"H

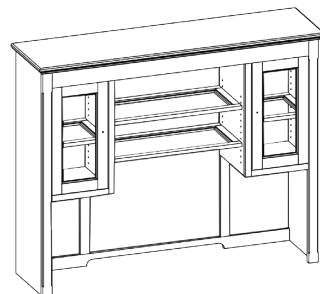

**Hutch Top for Credenza Desk**  
#88452 For 60" Credenza  
16"D x 60"W x 48"H  
#88453 For 66" Credenza  
16"D x 66"W x 48"H  
#88454 For 72" Credenza  
16"D x 72"W x 48"H



**Bookcase**  
#88430 15"D x 24"W x 72"H  
#88434 15"D x 36"W x 72"H  
#88438 15"D x 36"W x 48"H



**Executive Bookcase with Sliding Doors and 2 File Drawers**  
#88447 20"D x 48"W x 78"H



- Room Scene Includes:**
- A. #88403 Double Pedestal Credenza Desk
  - B. #88434 Bookcase
  - C. #230 Lydia Arm Chair with gas lift
- Shown with Capone Blond leather and Old Brass nails.

Shown in Maple with Kona stain with custom hardware.

# Rialto

OFFICE



Room scene includes:

- A. #88701 Double Pedestal Jr Executive Desk
- B. #88705 2 Drawer File Cabinet
- C. #88715 Bookcase with 2 File Drawers and Wood Doors

Shown in Retreat White Oak with YWF 4318 stain and Preen finish.

Hardware: 5319-BB



Pop-up Power Outlet with two electrical and 2 USB ports is Standard in all Executive Desks.

\*Located center of desk





Writing Desk  
#88700 24"D x 66"W x 31"H



Double Pedestal Jr Executive Desk  
#88701 30"D x 72"W x 30"H  
#88702 30"D x 66"W x 30"H



2 Drawer File Cabinet  
#88705 21"D x 36"W x 35"H  
3 Drawer File Cabinet  
#88706 21"D x 36"W x 49"H

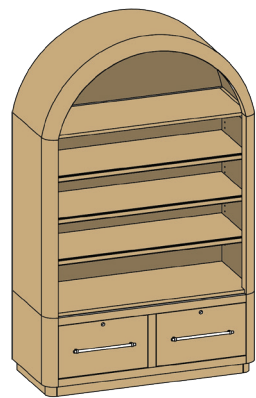

Bookcase with 2 File Drawers  
#88720 20"D x 48"W x 78"H

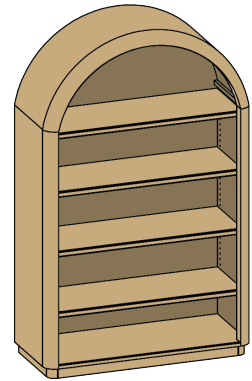

Bookcase  
#88710 20"D x 48"W x 78"H



Bookcase with 2 File Drawers & Wood Doors and Shelves  
#88715 20"D x 48"W x 78"H

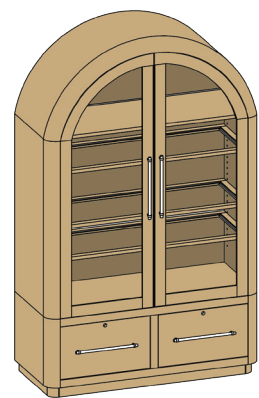

Bookcase with 2 File Drawers & Glass Doors and Shelves  
#88718 20"D x 48"W x 78"H



A. #88700 Writing Desk  
B. #2418 Console with 2 Doors  
Shown in Retreat White Oak with 4119 Memphis stain.

C. #230A Lydia Arm Chairs  
Shown in Maple with Saddle stain.  
Upholstery: Desantis Coffee faux leather with Natural nail heads.

D. 87S LaCroix Side Chair  
Shown in Maple with 140 Cappuccino stain.



- A. #2415 Console
- B. #2400 Cocktail Table
- C. #2405 End Table with Door
- D. #2410 Hall Console

Shown in Retreat White Oak  
with YWF 4318 stain and  
Preen finish.

Hardware: Long Pull: 5319-BB  
Short Pull: 596-BB

Hardware Finish Options

-  Brushed Nickel  
Long Pull: 5319SN  
Short Pull: 596SN



Room scene includes:  
A. #2418 Console  
B. #2400 Cocktail Table  
C. #2406 End Table with Drawer

Shown in Retreat White Oak  
with 4119 Memphis stain.  
Hardware: Long Pull: 5319-BB  
Short Pull: 596-BB



Cocktail Table  
#2400 27"D x 48"W x 18"H  
#2401 48"D x 48"W x 18"H



Console with 4 Doors  
#2415 19"D x 72"W x 38"H  
#2416 19"D x 84"W x 38"H



End Table with Door  
#2405 25"D x 25"W x 24"H



Console with 2 Doors  
#2417 19"D x 72"W x 38"H  
#2418 19"D x 84"W x 38"H



End Table with Drawer  
#2406 25"D x 25"W x 24"H



Hall Console  
#2410 18"D x 70"W x 30"H



- A. #88504 Double Pedestal Executive Desk
- B. #501A Venice Arm Chair
- C. #88547 Executive Bookcase with File Drawers and Glass Doors
- D. #88534 Bookcase
- E. #88522 2-Drawer File Cabinet

Shown in Retreat Cherry with 104 Seely stain and 230 Onyx on bases.

Hardware: 01A2835



Pop-up Power Outlet with two electrical and 2 USB ports is Standard in all Executive Desks.

\*Located center of desk



Grommet is Standard in all Jr. Executive Desks and Returns.

\*Located right side of knee hole



**Drawing Desk**  
#88500 24"D x 50"W x 30"H  
#88502 28"D x 60"W x 30"H



**Double Pedestal Jr. Executive Desk**  
#88508 30"D x 66"W x 31"H Knee-hole 28"W x 25"H  
#88509 30"D x 60"W x 31"H Knee-hole 30"W x 25"H  
#88510 30"D x 72"W x 31"H Knee-hole 34"W x 25"H



**Double Pedestal Executive Desk**  
#88504 36"D x 66"W x 31"H Knee-hole 28"W x 25"H  
#88506 36"D x 60"W x 31"H Knee-hole 30"W x 25"H  
#88507 36"D x 72"W x 31"H Knee-hole 34"W x 25"H

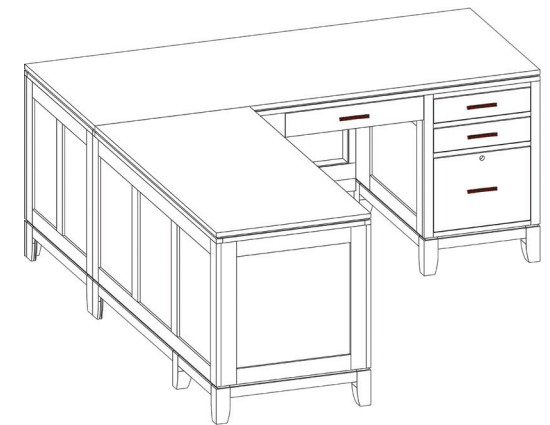

**Single Pedestal Executive Desk**  
30"D x 72"W x 31"H  
#88560 with Right Side L-Return 25"D x 52"W x 31"H  
#88561 with Left Side L-Return 25"D x 52"W x 31"H

A. #88505 Double Pedestal Credenza

B. #88552 Hutch Top for Credenza/Desk

Shown in Red Oak in Natural stain with Black glaze.

Hardware: Pull: YWF4518-SAB  
\* Shown with custom hardware

C. #514A Tuscany Arm Chair with desk chair base

Shown in Red Oak with YWF4418 stain and Desantix Mink Faux leather upholstery.



**Double Pedestal Credenza**  
#88503 24"D x 66"W x 31"H Knee-hole 28"W x 25"H  
#88505 24"D x 60"W x 31"H Knee-hole 30"W x 25"H  
#88517 24"D x 72"W x 31"H Knee-hole 34"W x 25"H

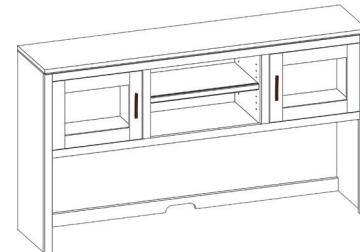

**Hutch Top**  
#88551 For 54" Credenza/Desk 14"D x 52"W x 36"H  
#88552 For 60" Credenza/Desk 14"D x 58"W x 36"H  
#88553 For 66" Credenza/Desk 14"D x 64"W x 36"H  
#88554 For 72" Credenza/Desk 14"D x 70"W x 36"H



**Single Pedestal Credenza**  
#88501 24"D x 54"W x 31"H Knee-hole 33"W x 25"H

OCCASIONAL



**2 Drawer File Cabinet**  
#88522 21"D x 19"W x 33"H



**3 Drawer File Cabinet**  
#88521 21"D x 19"W x 46"H



**4 Drawer File Cabinet**  
#88520 21"D x 19"W x 59"H



**Bookcase**  
#88530 15"D x 24"W x 72"H  
#88534 15"D x 36"W x 72"H  
#88538 15"D x 36"W x 48"H

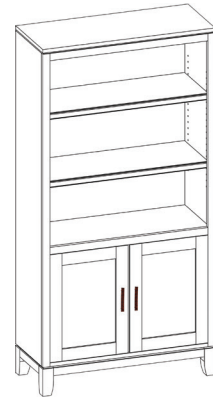

**Bookcase with Panel Doors**  
#88535 15"D x 36"W x 72"H

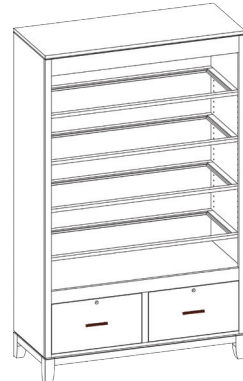

**Executive Bookcase with 2 File Drawers**  
#88546 20"D x 48"W x 78"H



**Executive Bookcase with Doors and 2 File Drawers**  
#88547 20"D x 48"W x 78"H



**Bookcase for Top of Lateral File Cabinet**  
#88524 18"D x 35"W x 42"H  
**2 Drawer Lateral File Cabinet**  
#88523 21"D x 36"W x 33"H



**Room Scene Includes:**  
A. #2101 Cocktail Table  
B. #2109 Round Lamp Table

Shown in Maple with 231 Charcoal stain.



Console  
#2117 18"D x 60"W x 30"H  
Shown in Retreat Cherry with  
104 Seely stain on Top 230 Onyx  
stain on trim & bases.



Round Lamp Table  
#2109 In Onyx 25" RND x 24"H  
End Table  
#2110 In Onyx 26"D x 20"W x 24"H



Cocktail Table  
#2101 In Onyx 24"D x 42"W x 18"H  
#2102 In Onyx 27"D x 48"W x 18"H



Console  
#2118 19"D x 72"W x 33"H  
(optional wood doors)

Shown in Maple with 231 Charcoal stain.  
Hardware: OIA2835



**Console**

#2119 18"D x 72"W x 44"H  
Shown with optional wood doors

Shown in Retreat Cherry  
with Saddle stain.

Hardware: 01A2835



**Tall Cabinet**

#2120 15"D x 36"W x 84"H

Shown in Maple with Onyx stain.

Hardware: 5319-SN



**Server**

#54-5533 20"D x 55"W x 33"H

Shown in Retreat Cherry with 104 Seely stain  
with 230 Onyx base.

Hardware: 01A2835

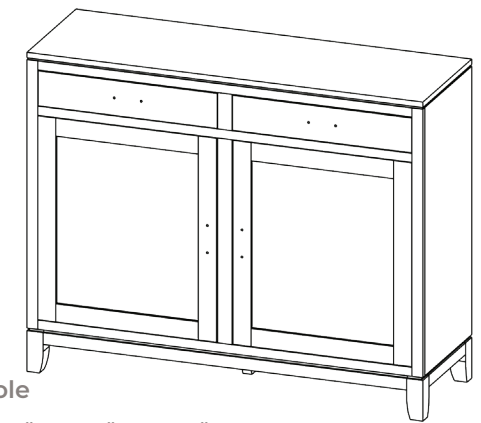

**Console**

#2121 18"D x 55"W x 44"H

# Chairs

## ADDITIONAL CHAIR OPTIONS

- Fabric seat / faux leather adds approximately 2 inches to the height of the seat
- Leather seat adds approximately 2 inches to the height of the seat
- Upholstery nails
- 24" stationary counter stool
- 30" stationary bar stool
- 24" swivel counter stool
- 30" Swivel bar stool
- Desk chair base



Wood Seat Only  
No Two Tone

**#51A Buckeye Arm Chair**  
Seat 20.25"W x 16"D x 17.5"H  
Chair 23"W x 23"D x 41.75"H  
Arm 26"H



Wood Seat Only  
No Two Tone

**#51S Buckeye Side Chair**  
Seat 18.5"W x 15.25"D x 17.5"H  
Chair 23"W x 21"D x 41.75"H



**#87A LaCroix Arm Chair**  
Seat 19.75"W x 17"D x 17.5"H  
Chair 22.5"W x 21.5"D x 35.25"H  
Arm 25.25"H



**#87S LaCroix Side Chair**  
Seat 18.25"W x 16.25"D x 17.5"H  
Chair 18.25"W x 20.5"D x 35.75"H



**#207A Mansfield A Arm Chair**  
Seat 18.5"W x 17.25"D x 17.75"H  
Chair 24"W x 22"D x 40.5"H  
Arm 25.5"H



**#207S Mansfield A Side Chair**  
Seat 18.5"W x 17.25"D x 17.75"H  
Chair 18.5"W x 22"D x 40.5"H



**#99A Ladder Arm Chair**  
Seat 18"W x 16"D x 17.5"H  
Chair 24.5"W x 21.75"D x 40.25"H  
Arm 25"H



**#99S Ladder Side Chair**  
Seat 18"W x 16"D x 17.5"H  
Chair 18"W x 21.75"D x 40.25"H



**#85A Mission Arm Chair**  
Seat 19"W x 18"D x 17.75"H  
Chair 24"W x 23.75"D x 41.75"H  
Arm 26"H



**#85S Mission Side Chair**  
Seat 19"W x 18"D x 17.75"H  
Chair 19.25"W x 23.75"D x 41.75"H



**#512A Laker Arm Chair**  
Seat 18"W x 17.25"D x 18"H  
Chair 22"W x 19.5"D x 37.5"H  
Arm 25.5"H

**#512S Laker Side Chair**  
Seat 18"W x 17.25"D x 18"H  
Chair 18.25"W x 19.5"D x 37.5"H



**#513A Venetian Arm Chair**  
Seat 18"W x 17.25"D x 18"H  
Chair 22"W x 19.5"D x 37.5"H  
Arm 25.5"H

**#513S Venetian Side Chair**  
Seat 18"W x 17.25"D x 18"H  
Chair 18.25"W x 19.5"D x 37.5"H



**#514A Tuscany Arm Chair**  
Seat 18.5"W x 17.25"D x 17.5"H  
Chair 18.5"W x 19.75"D x 40"H  
Arm 25.25"H

**#514S Tuscany Side Chair**  
Seat 18.5"W x 17.25"D x 17.5"H  
Chair 18.5"W x 19.75"D x 40"H

# Chairs



## ADDITIONAL CHAIR OPTIONS

- Fabric seat / faux leather adds approximately 2 inches to the height of the seat
- Leather seat adds approximately 2 inches to the height of the seat
- Upholstery nails
- 24" stationary counter stool
- 30" stationary bar stool
- 24" swivel counter stool
- 30" Swivel bar stool
- Desk chair base



**#208A Mansfield Arm Chair**  
Seat 18.5"W x 17.25"D x 17.75"H  
Chair 24"W x 22"D x 40.5"H  
Arm 25.5"H

**#208S Mansfield Side Chair**  
Seat 18.5"W x 17.25"D x 17.75"H  
Chair 18.5"W x 22"D x 40.5"H



**#210A Mansfield C Arm Chair**  
Seat 18.5"W x 17.25"D x 17.75"H  
Chair 24"W x 22"D x 40.5"H  
Arm 25.5"H

**#210S Mansfield C Side Chair**  
Seat 18.5"W x 17.25"D x 17.75"H  
Chair 18.5"W x 22"D x 40.5"H



**#9002A Christy Arm Chair**  
Seat 19"W x 18.5"D x 18"H  
Chair 24.5"W x 23"D x 42"H  
Arm 25.5"H

**#9002S Christy Side Chair**  
Seat 19"W x 18.5"D x 18"H  
Chair 19"W x 23"D x 42"H



**#6020A Adena Arm Chair**  
Seat 19"W x 18.5"D x 18"H  
Chair 24.5"W x 23"D x 42"H  
Arm 25.5"H

**#6020S Adena Side Chair**  
Seat 19"W x 18.5"D x 18"H  
Chair 20"W x 23"D x 42"H



**#178A Chesterfield Arm Chair**  
Seat 20"W x 16.25"D x 17.5"H  
Chair 24.5"W x 22.5"D x 39"H  
Arm 22.5"H



**#178S Chesterfield Side Chair**  
Seat 20"W x 16.25"D x 17.5"H  
Chair 20"W x 22.5"D x 39"H



**#501A Venice Arm Chair**  
Seat 18.75"W x 17"D x 18.25"H  
Chair 24.25"W x 21.25"D x 36"H  
Arm 25.5"H



**#501S Venice Side Chair**  
Seat 18.75"W x 17"D x 18.25"H  
Chair 19.75"W x 21.25"D x 36"H



No Inlay

**#511A Veneto Arm Chair**  
Seat 18.75"W x 17"D x 18.25"H  
Chair 24.25"W x 21.25"D x 36"H  
Arm 25.5"H



No Inlay

**#511S Veneto Side Chair**  
Seat 18.75"W x 17"D x 18.25"H  
Chair 19.75"W x 21.25"D x 36"H



**#500A Trieste Arm Chair**  
Seat 18.75"W x 17"D x 18.25"H  
Chair 24.25"W x 21.25"D x 36"H  
Arm 25.5"H

**#500S Trieste Side Chair**  
Seat 18.75"W x 17"D x 18.25"H  
Chair 19.75"W x 21.25"D x 36"H



No Inlay

**#510A Torlonia Arm Chair**  
Seat 18.75"W x 17"D x 18.25"H  
Chair 24.25"W x 21.25"D x 36"H  
Arm 25.5"H



No Inlay

**#510S Torlonia Side Chair**  
Seat 18.75"W x 17"D x 18.25"H  
Chair 19.75"W x 21.25"D x 36"H

# Chairs



## ADDITIONAL CHAIR OPTIONS

- Fabric seat / faux leather adds approximately 2 inches to the height of the seat
- Leather seat adds approximately 2 inches to the height of the seat
- Upholstery nails
- 24" stationary counter stool
- 30" stationary bar stool
- 24" swivel counter stool
- 30" Swivel bar stool
- Desk chair base



**#1171A Ashburn Arm Chair**  
Seat 19"W x 16"D x 17.75"H  
Chair 24.5"W x 24"D x 40"H  
Arm 25.5"H

**#1171S Ashburn Side Chair**  
Seat 19"W x 16"D x 17.75"H  
Chair 19"W x 24"D x 40"H



**#610A Ramsey Arm Chair**  
Seat 19.75"W x 17.25"D x 18"H  
Chair 24"W x 21.5"D x 40.5"H  
Arm 25"H



**#610S Ramsey Side Chair**  
Seat 20"W x 17.25"D x 18"H  
Chair 20"W x 21.5"D x 40.5"H



**#620A Callahan Arm Chair**  
Seat 18"W x 17"D x 17.5"H  
Chair 21.5"W x 23.25"D x 39.75"H  
Arm 25.25"H



**#620S Callahan Side Chair**  
Seat 18.75"W x 16.75"D x 17.5"H  
Chair 19.75"W x 23.25"D x 39.75"H



**#630A Braxton Arm Chair**  
Seat 17.5"W x 17"D x 18"H  
Chair 21.5"W x 20"D x 37"H  
Arm 25.25"H



**#630S Braxton Side Chair**  
Seat 17.5"W x 17"D x 18"H  
Chair 17.5"W x 20"D x 37"H



**#640A Linzee Arm Chair**  
Seat 18.5"W x 17.5"D x 17.25"H  
Chair 21.5"W x 22.25"D x 39.25"H  
Arm 25"H



**#604S Linzee Side Chair**  
Seat 18.25"W x 17"D x 17.25"H  
Chair 18.25"W x 22.25"D x 39.25"H



**#70S Napoleon Side Chair**  
Seat 18.25"W x 16"D x 18"H  
Chair 19.5"W x 23"D x 41"H



**#70A Napoleon Arm Chair**  
Seat 18.25"W x 16"D x 18"H  
Chair 22.5"W x 23"D x 41"H  
Arm 25"H



**#5885A Albany Arm Chair**  
Seat 19"W x 17"D x 17.75"H  
Chair 24"W x 23"D x 42"H  
Arm 25.5"H

**#5885S Albany Side Chair**  
Seat 19"W x 17"D x 17.75"H  
Chair 19"W x 23"D x 42"H



**#264S Rialto Side Chair**  
Seat 20"W x 18"D x 17.75"H  
Chair 20"W x 24"D x 37"H



**#265S Clair Side Chair**  
Seat 18.5"W x 16.5"D x 18"H  
Chair 18.5"W x 21.25"D x 36.75"H

**#265A Clair Arm Chair**  
Seat 18.25"W x 16.5"D x 18"H  
Chair 22.5"W x 21.25"D x 36.75"H  
Arm 25.5"H

# Chairs

## ADDITIONAL CHAIR OPTIONS

- Fabric seat / faux leather adds approximately 2 inches to the height of the seat
- Leather seat adds approximately 2 inches to the height of the seat
- Upholstery nails
- 24" stationary counter stool
- 30" stationary bar stool
- 24" swivel counter stool
- 30" Swivel bar stool
- Desk chair base



**#680S Ava Side Chair**  
Seat 19.5"W x 18"D x 18.75"H  
Chair 20"W x 24"D x 37.5"H



*Shown with optional Upholstery Nails*

**#228A LaRose Arm Chair**  
Seat 19.5"W x 17"D x 19"H  
Chair 24"W x 24"D x 40"H  
Arm 25.5"H



*Shown with optional Upholstery Nails*

**#228S LaRose Side Chair**  
Seat 19.5"W x 17"D x 19"H  
Chair 19.5"W x 24"D x 40"H



*Shown with optional Upholstery Nails*

**#229A Marquette Arm Chair**  
Seat 19.5"W x 17"D x 19"H  
Chair 24"W x 24"D x 41"H  
Arm 25.5"H

**#229S Marquette Side Chair**  
Seat 19.5"W x 17"D x 19"H  
Chair 19.5"W x 24"D x 41"H



*Shown with optional Upholstery Nails*

**#230A Lydia Arm Chair**  
Seat 19.5"W x 17"D x 19"H  
Chair 24"W x 24"D x 40"H  
Arm 25.5"H



*Shown with optional Upholstery Nails*

**#230S Lydia Side Chair**  
Seat 19.5"W x 17"D x 19"H  
Chair 19.5"W x 24"D x 40"H



*Shown with optional Upholstery Nails*

**#999A Parsons Arm Chair**  
Seat 19"W x 18.5"D x 18"H  
Chair 23.5"W x 28"D x 40"H  
Arm 25.5"H



*Shown with optional Upholstery Nails*

**#999S Parsons Side Chair**  
Seat 19"W x 18.5"D x 18"H  
Chair 19"W x 28"D x 40"H



**#231A Seymour Arm Chair**  
Seat 19.5"W x 17"D x 19"H  
Chair 24"W x 24"D x 43"H  
Arm 25.5"H

**#231S Seymour Side Chair**  
Seat 19.5"W x 17"D x 19"H  
Chair 19.5"W x 24"D x 43"H



**#263A Montour Arm Chair**  
Seat 19.5"W x 17"D x 19"H  
Chair 24"W x 24"D x 41"H  
Arm 25"H



**#263S Montour Side Chair**  
Seat 19.5"W x 17"D x 19"H  
Chair 19.5"W x 24"D x 41"H



**#240S Stella Side Chair**  
Seat 19.5"W x 17"D x 19"H  
Chair 19.5"W x 24"D x 34"H

**#240 Stella Arm Chair**  
Seat 19.5"W x 17"D x 19"H  
Chair 24"W x 24"D x 34"H  
Arm 25.5"H



**#600 Bristow Chair Back**

**#600 Bristow Chair**  
Seat 22"W x 18.25"D x 20"H  
Chair 23.5"W x 27.25"D x 41.75"H

# Chair OPTIONS

## ADDITIONAL CHAIR OPTIONS

- Fabric seat / faux leather adds approximately 2 inches to the height of the seat
- Leather seat adds approximately 2 inches to the height of the seat
- Upholstery nails
- 24" stationary counter stool
- 30" stationary bar stool
- 24" swivel counter stool
- 30" Swivel bar stool
- Desk chair base



#620S Callahan Side Chair  
as a Counter Height Swivel Stool



#620S Callahan Side Chair  
as a Counter Height  
Stationary Stool



#87S LaCroix Side Chair  
as a Counter Height Swivel Stool



#87S LaCroix Side Chair  
as a Counter Height  
Stationary Stool



#514A Tuscany Arm Chair  
with a Desk Base (5 star gas lift)



#87A LaCroix Arm Chair  
with a Desk Base (5 star gas lift)

# Stools



A. #88904 Liberty Library Desk

B. #503 24" Saddle Stool

Upholstered with Desantis  
Mink Faux Leather and Pewter  
nail heads



#503  
24" Upholstered  
Saddle Stool



#1125 30" Turnstone  
Stationery Bar Stool  
Seat 17.5"W x 16"D x 24"H  
Chair 18"W x 18.25"D x 33.5"H

#1122 24" Turnstone  
Stationery Bar Stool  
Seat 17.5"W x 16"D x 30"H  
Chair 18"W x 18.5"D x 39.5"H

Shown  
with optional  
Upholstery  
Nails



#504  
30" Upholstered  
Saddle Stool



See our other  
Solid Wood  
Furniture  
Collections



## Bedroom

Solid Wood Beds, Dressers,  
Chests, Nightstands & Mirrors



## Dining

Solid Wood Tables, Chairs,  
& Servers



Visit us on the web for more  
information or to see our other  
collections.

Scan the QR Code to go directly  
to our website.

Or enter  
UrbanCollectionsOhioUSA.com  
into your browser.

# Stains



These pictured samples are close color representations of our stains on various wood species and are not meant to replace looking at a physical sample in the showroom. Color variations and graining differences **are natural** and are an **acceptable and desirable** quality of fine solid wood furniture.

## Maple

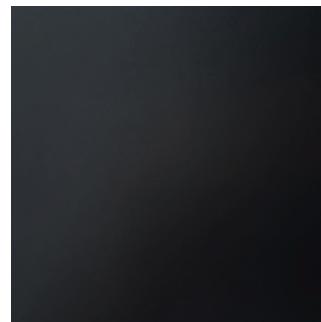

**M1**  
158 Black Stain  
on Maple



**M2**  
156 Mocha Stain  
on Maple



**M3**  
233 Chestnut Stain  
on Maple



**M4**  
157 Kona Stain  
on Maple



**M5**  
140 Cappuccino  
Stain on Maple

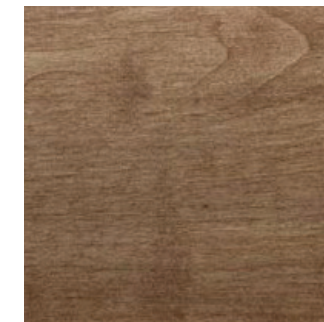

**M6**  
111 Boston Stain  
on Maple

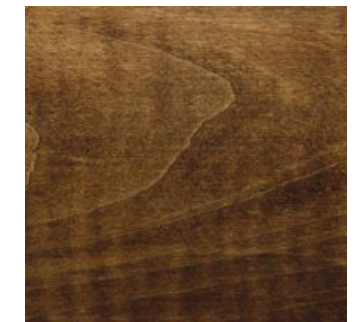

**M7**  
113 Michaels Stain  
on Maple



**M8**  
348-127 Royal Cottage  
Stain on Maple



**M9**  
160 Earth Tone Stain  
on Maple

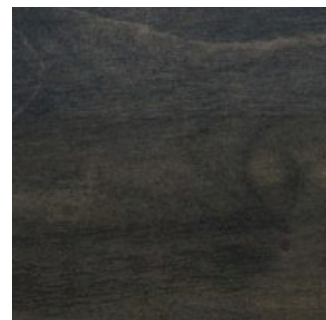

**M10**  
137 Antique Slate Stain  
on Maple

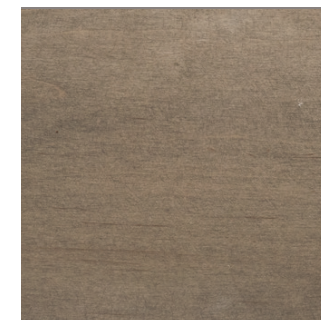

**M11**  
YWF 1042 aka Ryan's  
Driftwood Stain on Maple

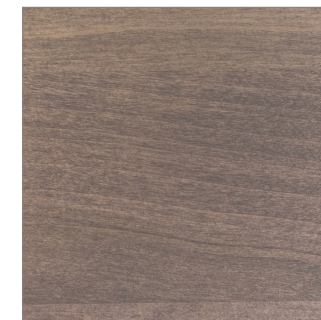

**M12**  
232 Driftwood Stain  
on Maple

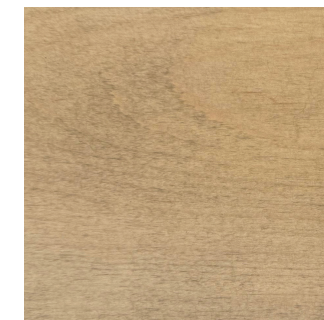

**M13**  
Desert Stain  
on Maple



**M14**  
136 Rustic Gray Stain  
on Maple

## Retreat White Oak

- Classic Weathered Finishes
- Wire Brushed



**W1**  
YWF 4218 Stain  
on Retreat White Oak



**W2**  
YWF 4418 Stain  
on Retreat White Oak

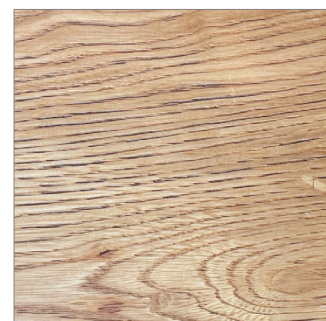

**W3**  
YWF 4318 Stain  
on Retreat White Oak

## Red Oak

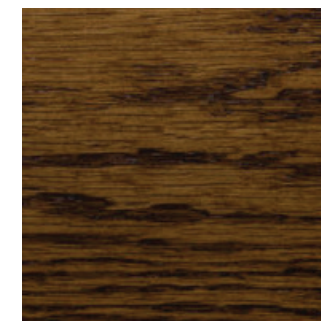

**O1**  
113 Michaels Stain  
on Red Oak



**O2**  
104 Seely Stain  
on Red Oak

# Stains



## Wormy Maple



**WM1**  
YWF 4218 Stain  
on Wormy Maple



**WM2**  
226 Coffee Stain  
on Wormy Maple

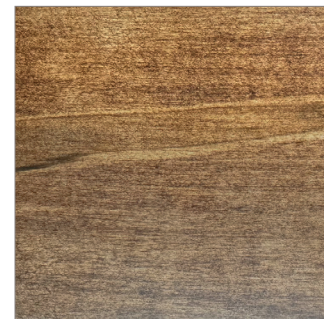

**WM3**  
160 Earth Tone Stain  
on Wormy Maple

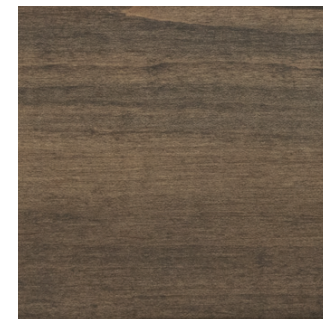

**WM4**  
140 Cappuccino Stain  
on Wormy Maple



**WM5**  
113 Michaels Stain  
on Wormy Maple

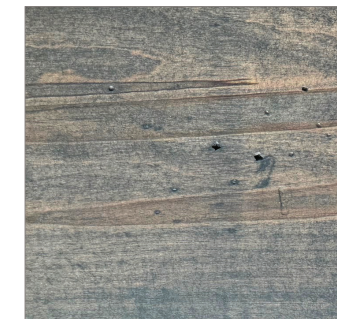

**WM6**  
137 Antique Slate Stain  
on Wormy Maple



**WM7**  
155 Blair 47823 Stain  
on Wormy Maple

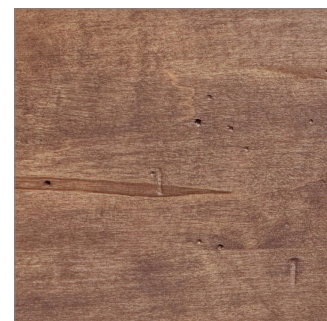

**WM8**  
232 Driftwood Stain  
on Wormy Maple



**WM9**  
Desert Stain  
on Wormy Maple

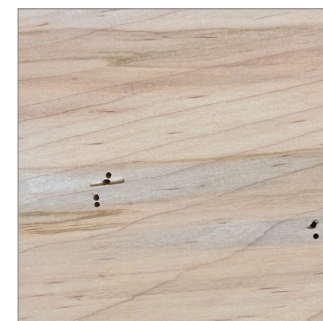

**WM10**  
WSC-024 Snow White  
Stain on Wormy Maple

# Stains



## Retreat White Oak



**RW01**  
158 Black Stain  
on Retreat White Oak

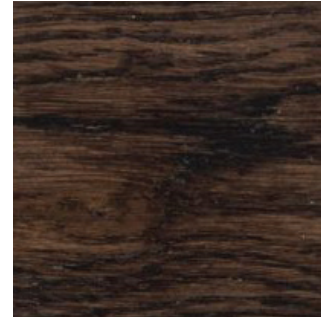

**RW02**  
YWF 4119 Memphis Stain  
on Retreat White Oak



**RW03**  
160 Earth Tone Stain  
on Retreat White Oak



**RW04**  
140 Cappuccino Stain  
on Retreat White Oak



**RW05**  
137 Antique Slate Stain  
on Retreat White Oak

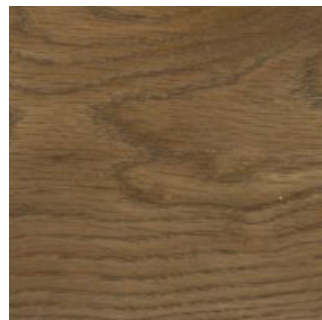

**RW06**  
155 Blair Stain  
on Retreat White Oak



**RW07**  
Brown Sugar Stain  
on Retreat White Oak



**RW08**  
YWF 4319 Sandstone Stain  
on Retreat White Oak



**RW09**  
WSC-024 Snow White  
Stain on Retreat White  
Oak



**RW10**  
Sea White Stain  
on Retreat White Oak

## Maple Paint



**P1**  
Black Paint with Rub Thru  
on Maple

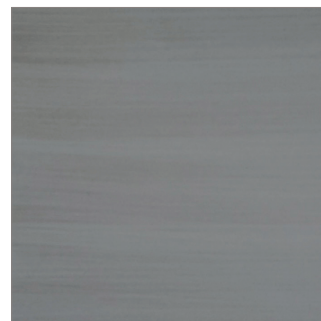

**P2**  
Dark Gray Paint with  
253 Glazing on Maple



**P3**  
Gray Paint on Maple



**P4**  
Light Gray Paint with  
253 Glazing on Maple



**P5**  
Cotton Paint on Maple



**P6**  
White Paint with  
253 Glazing on Maple



**P7**  
White Paint with  
251 Glazing on Maple

# Stains



## Retreat Cherry



**C1**  
158 Black Stain  
on Retreat Cherry

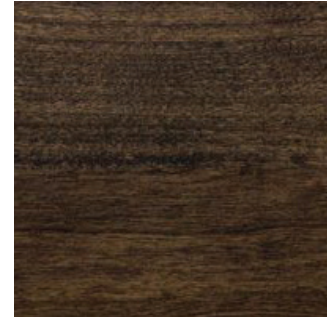

**C2**  
YWF 1023 aka 223  
Chestnut Stain  
on Retreat Cherry



**C3**  
4119 Memphis Stain  
on Retreat Cherry

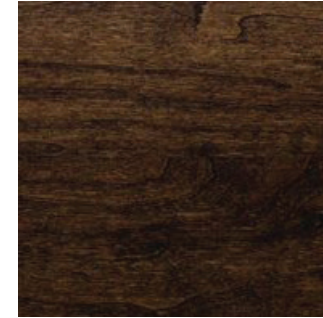

**C4**  
7992 Ashbury Stain  
on Retreat Cherry

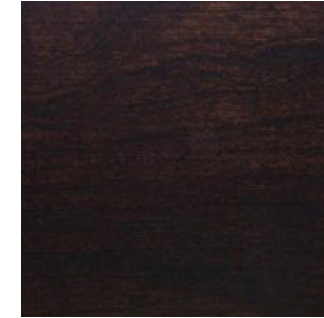

**C5**  
151 Generations Stain  
on Retreat Cherry



**C6**  
Coffee Stain  
on Retreat Cherry



**C7**  
152 Saddle FC-10759 Stain  
on Retreat Cherry

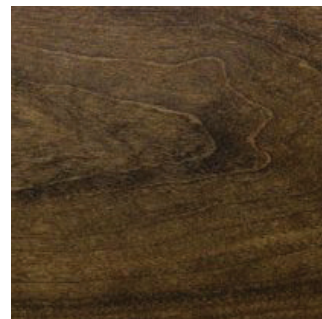

**C8**  
1133 Sunset Stain  
on Retreat Cherry

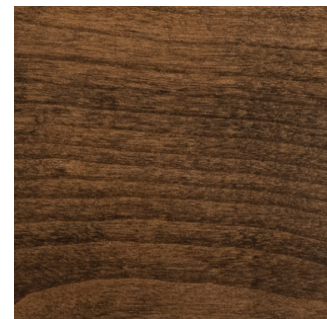

**C9**  
140 Cappuccino Stain  
on Retreat Cherry



**C10**  
160 Earthtone Stain  
on Retreat Cherry

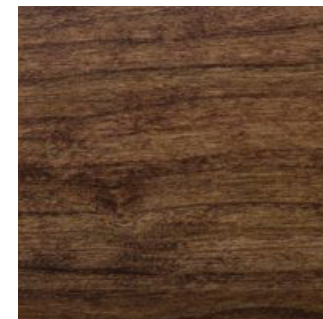

**C11**  
111 Boston Stain  
on Retreat Cherry

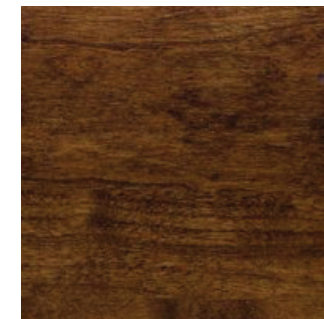

**C12**  
113 Michaels Stain  
on Retreat Cherry



**C13**  
159 Chocolate Spice Stain  
on Retreat Cherry

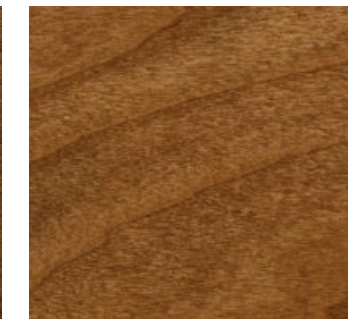

**C14**  
104 Seely Stain  
on Retreat Cherry

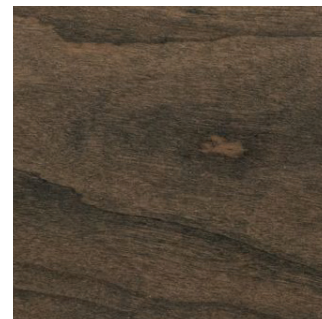

**C15**  
137 Antique Slate Stain  
on Retreat Cherry

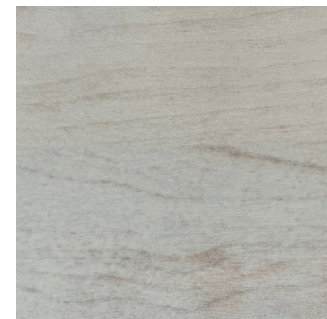

**C16**  
Shore Stain  
on Retreat Cherry



2441 US 62 • Dundee, OH 44624 • 330-359-6166  
[UrbanCollectionsOhioUSA.com](http://UrbanCollectionsOhioUSA.com)

©2025 Yutzy - 06/25 - Home Collections